

ROOM No. **118** BOO BOO ROOM ELEVATIONS SCALE: 3/8" = 1'-0"

ROOM No. **119** OFFICE ELEVATIONS SCALE: 3/8" = 1'-0"

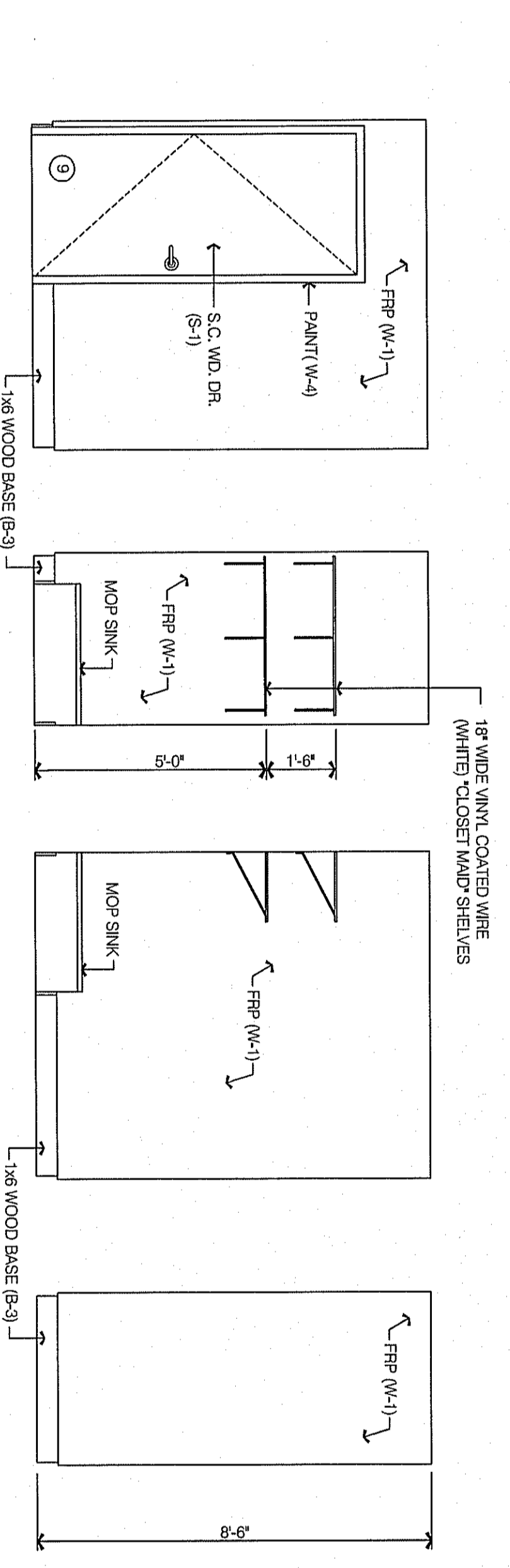

ROOM No. **119** UTILITY ROOM ELEVATIONS SCALE: 3/8" = 1'-0"

ROOM No. **120** NOT USED SCALE: 3/8" = 1'-0"

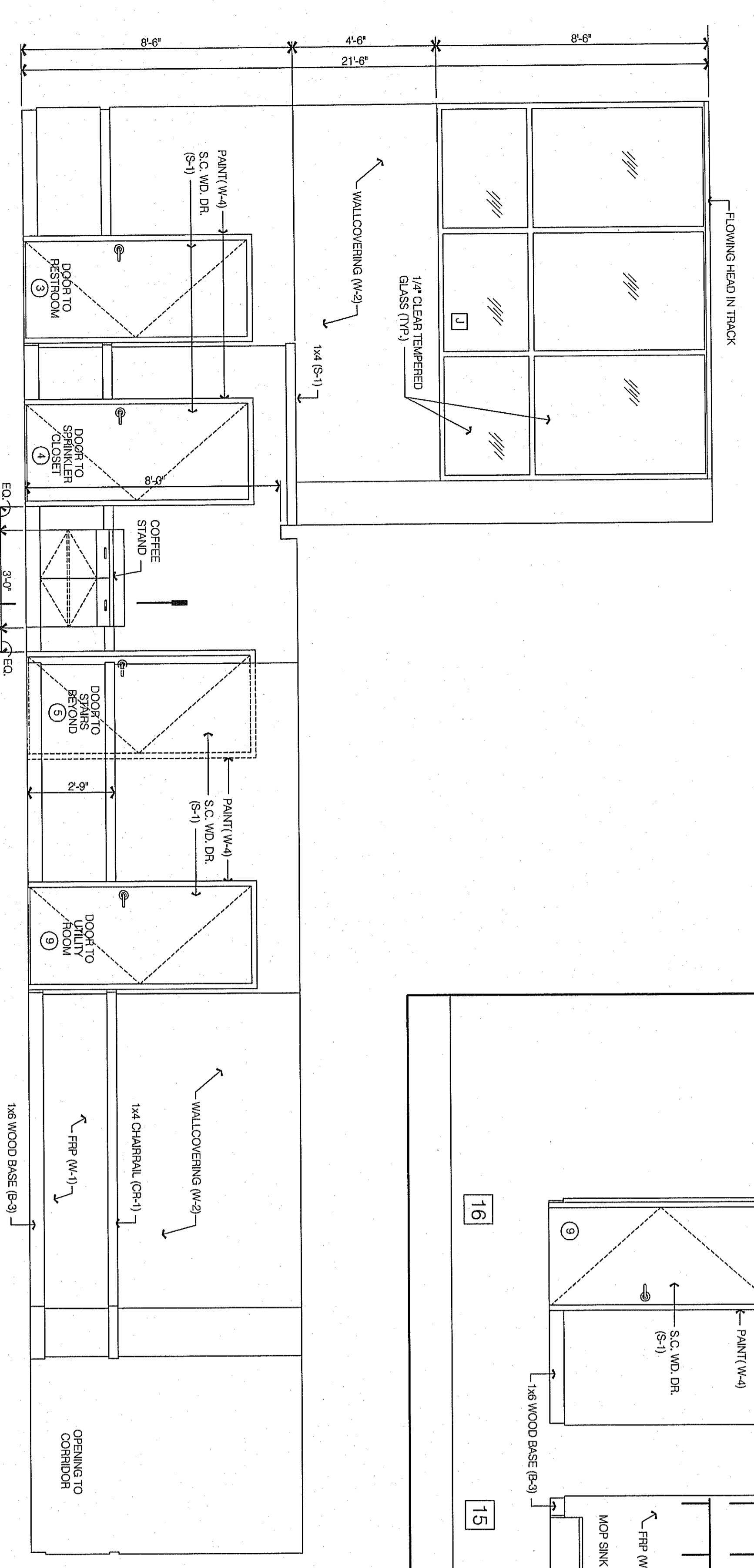

ROOM No. **120** MECHANICAL ROOM ELEVATIONS SCALE: 3/8" = 1'-0"

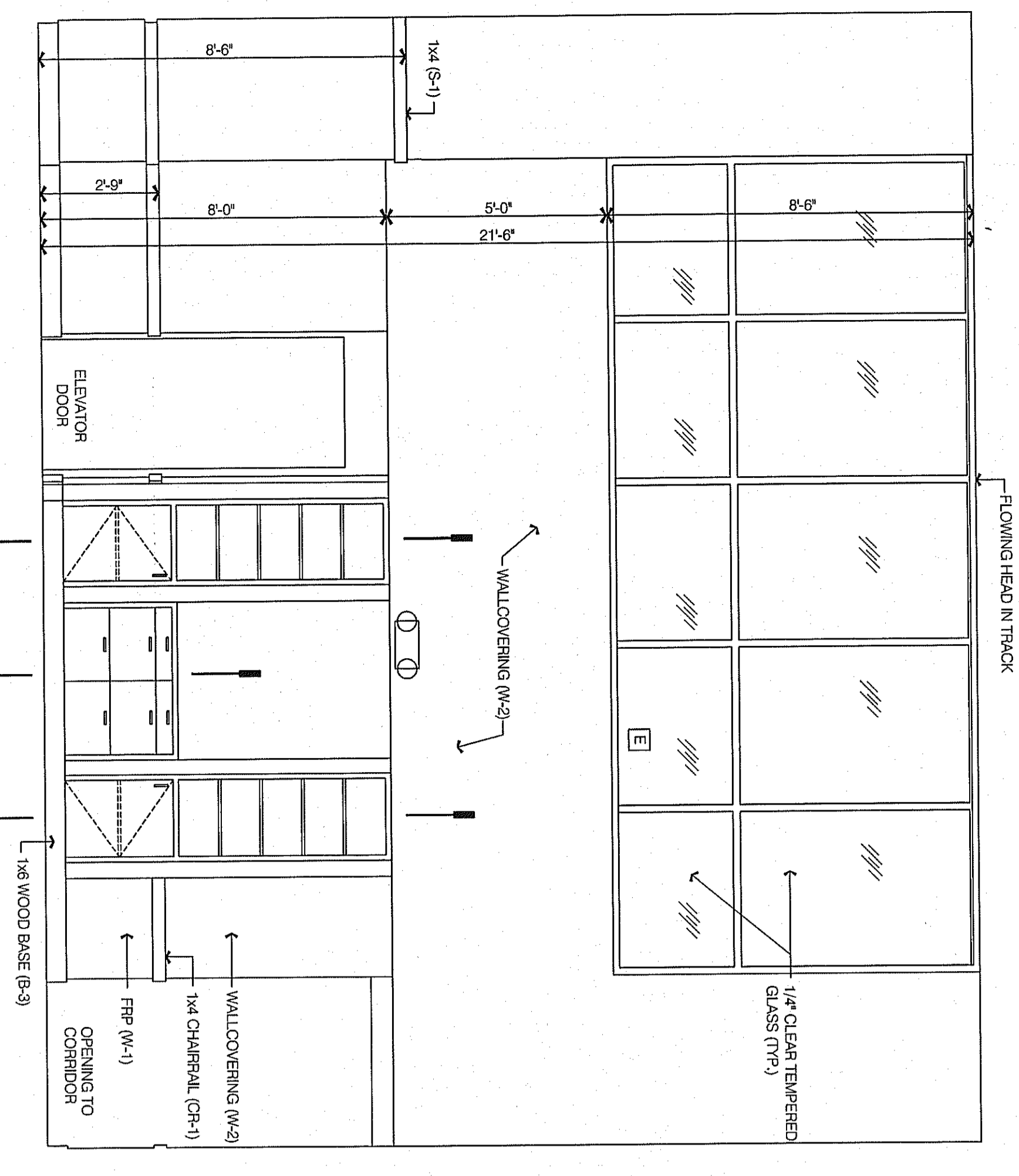
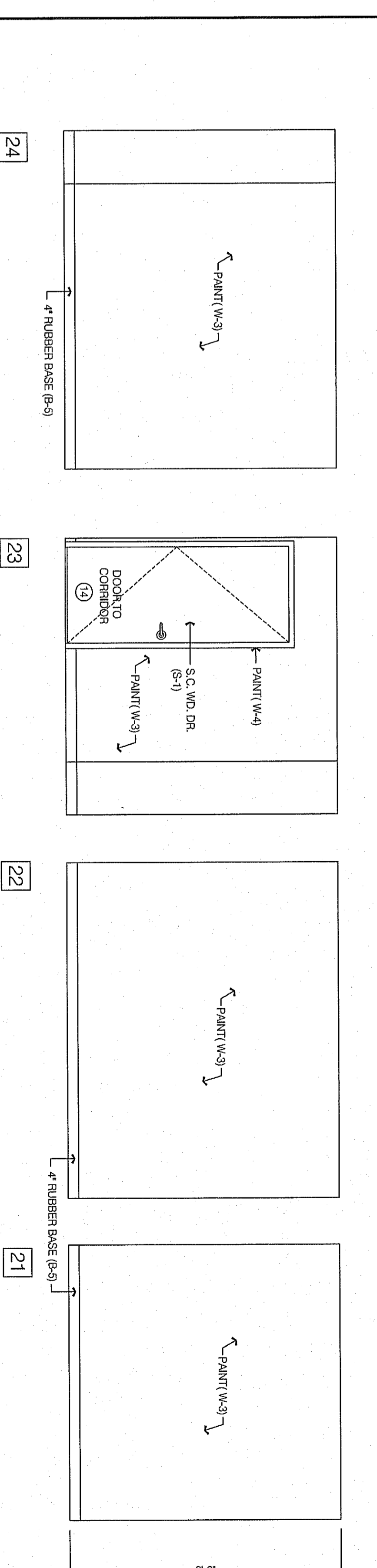

ROOM No. **121** ENTRY / RECEPTIONIST / CORRIDOR ELEVATIONS SCALE: 3/8" = 1'-0"

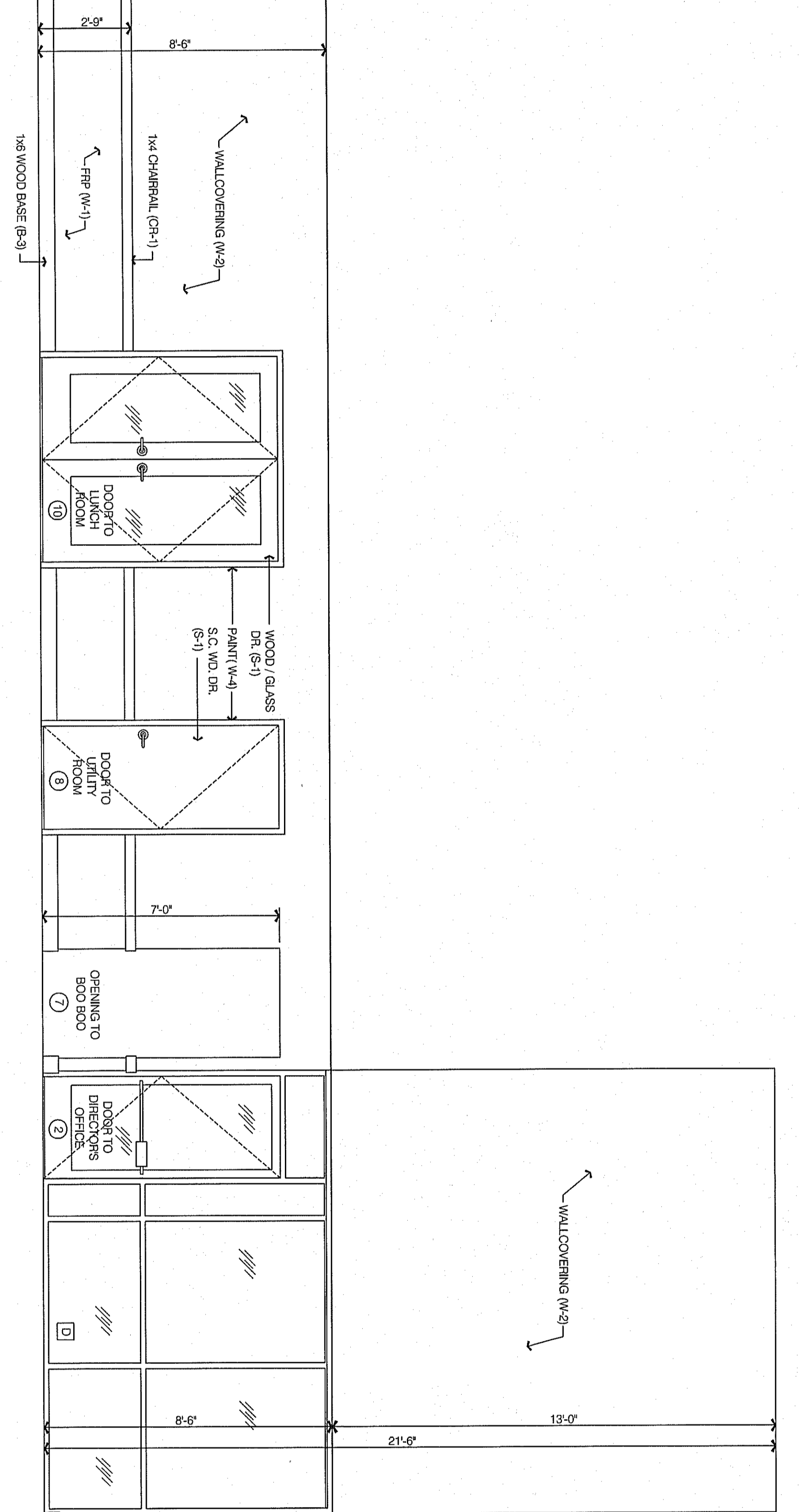

ROOM No. **121** ENTRY / RECEPTIONIST / CORRIDOR ELEVATIONS SCALE: 3/8" = 1'-0"

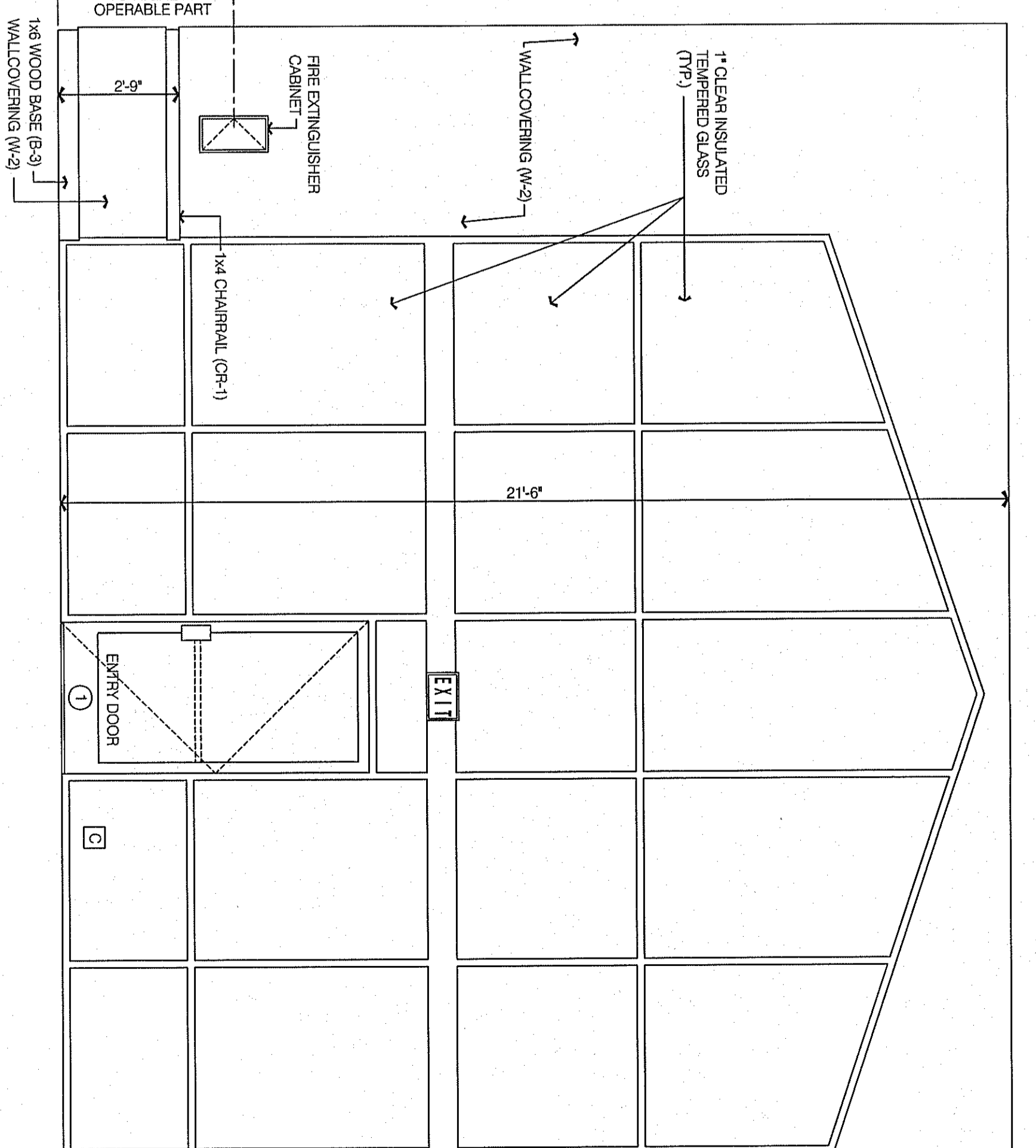

ROOM No. **121** ENTRY / RECEPTIONIST / CORRIDOR ELEVATIONS SCALE: 3/8" = 1'-0"

dennis j. dubey, architect
 6327 Point Twenty Two
 Gainesville, Georgia 30506
 Phone: 352-353-8525
 Fax: 352-353-8526
 E-Mail: djdar@bellsouth.net

PROFESSIONAL SEAL

NOT RELEASED FOR CONSTRUCTION

PROJECT LOCATION
 3802 OLD ATLANTA ROAD
 GAINESVILLE, GA 30601



REVISIONS

INTERIOR ELEVATIONS

DATE: 8-17-09
 PROJECT No.: 29001
 SHEET No.: A6.0

ROOM No. **120** & **121** ENTRY / RECEPTIONIST / CORRIDOR ELEVATIONS SCALE: 3/8" = 1'-0"

Note:
 1. RECEPTIONIST DESK NOT SHOWN FOR CLARITY.